

Latch Blocker Model U200 Installation Instructions

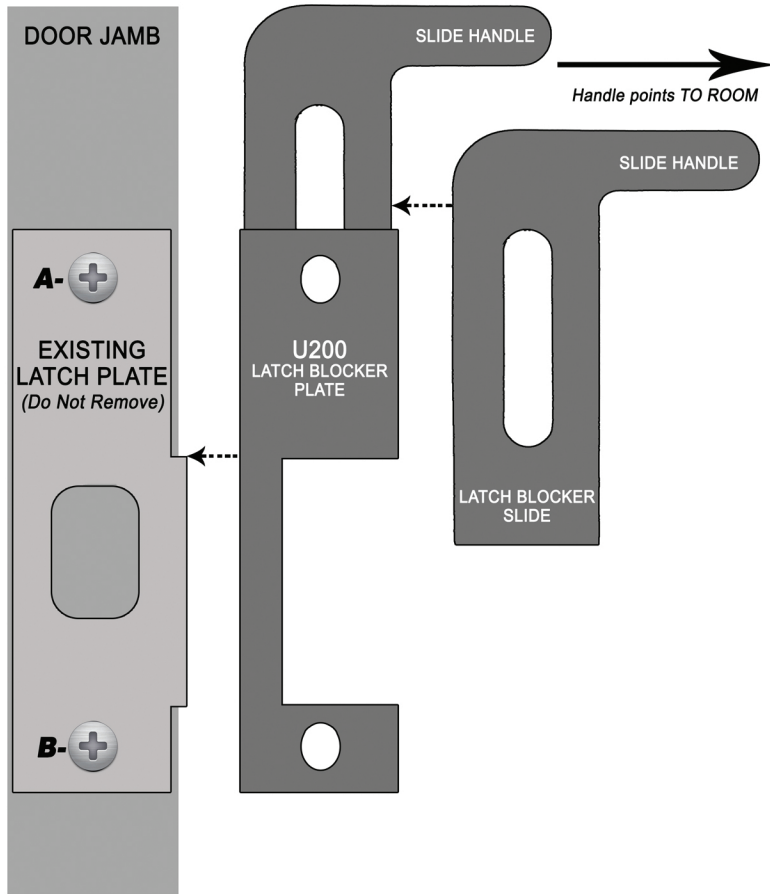

Installation:

1. Remove screws A&B, DO NOT REMOVE LATCHPLATE.
2. Assemble Latch Blocker Slide behind Latch Blocker Plate.
(slide handle should point toward room)
3. Place assembly over existing latch plate.
4. Place screws A&B through assembly and existing latch plate.
5. Tighten screws ensuring slide moves freely.

Latch Blocker Model U300 Installation Instructions

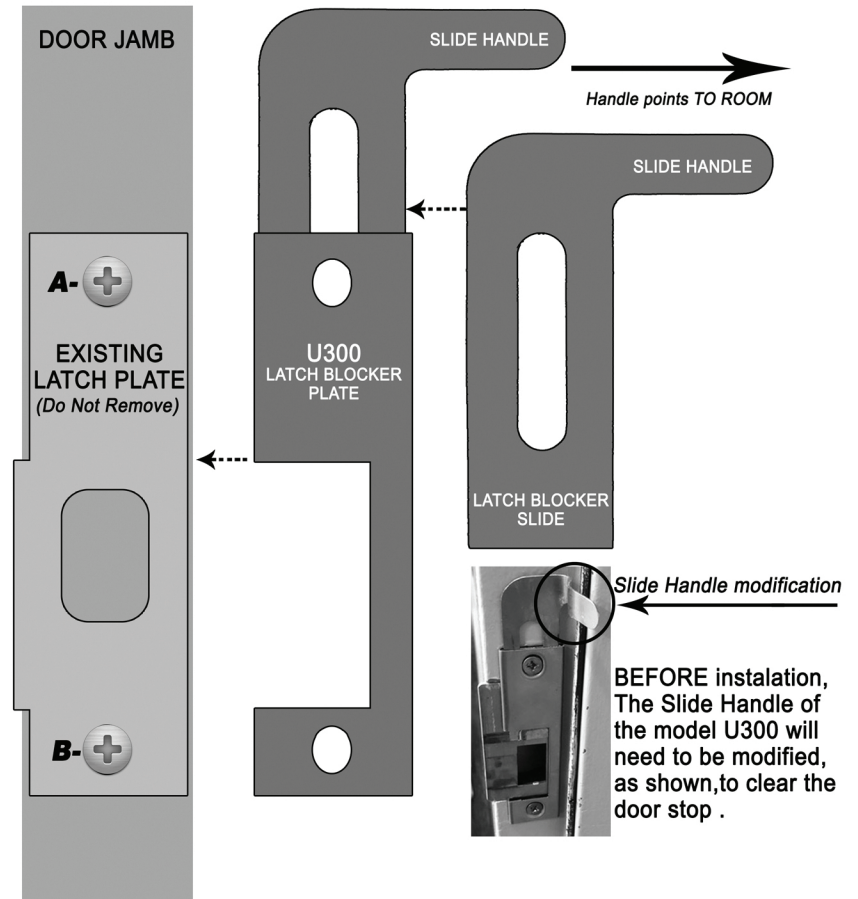

Installation:

1. Remove screws A&B , DO NOT REMOVE LATCHPLATE.
2. Assemble Latch Blocker Slide behind Latch Blocker Plate.
(slide handle should point toward room)
3. Place assembly over existing latch plate.
4. Place screws A&B through assembly and existing latch plate.
5. Tighten screws ensuring slide moves freely.